

# BUILDING VISUALISATION

Fly-throughs and physical models may give stakeholders a good notion of what a building might look like, but they give no idea of what it might be like to live or work in the new space.

Daden's 3D virtual building models allow stakeholders to explore a building as an avatar – a computer representation of themselves. They can walk through the building in their own time, from work or home, on their own or with others. They can even interact with the building's systems from lifts and escalators to lighting controls and computer screens.

A virtual build lets you and your users explore the social dimension of a building project, and provides you with a model that can be used by the client well after the build project itself is complete.

## FEATURES AND BENEFITS

- Model at any scale from 1:1 to 1:1,000,000 or more
- Change décor/furniture from within the build
- Support community engagement and consultation
- Explore access and disability issues
- Track how people use and move around the environment
- Hold project meetings in the build itself
- Access documents, images and video inside the building
- Visualise environment and performance data from sources such as BIM and real-world sensors
- Conduct training exercises within the build, e.g. health and safety, staff familiarisation and induction

## CLIENT PROJECTS HAVE INCLUDED

- Millennium Point, a 37,000sqm building for risk assessment training
- A major new UK public library for layout planning and public familiarisation
- A theatre auditorium and stage for set design and planning
- Birmingham City Centre at 1:70 scale
- A council chamber with voting capability and interactive displays
- Full Google Maps™ access inside the virtual world for a Middle East client

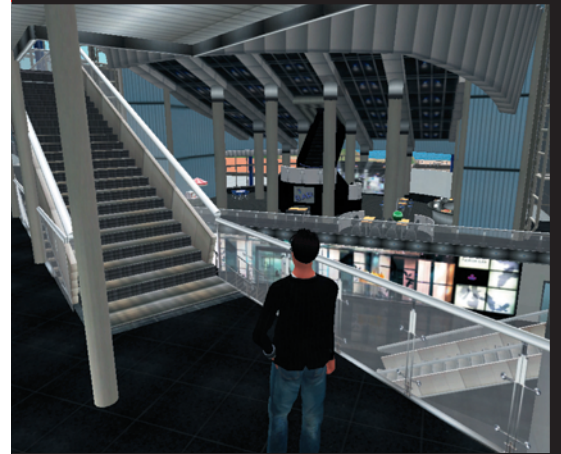

For more information please contact us:

[www.daden.co.uk](http://www.daden.co.uk) • [info@daden.co.uk](mailto:info@daden.co.uk) • 0121 250 5678

DADENLIMITED